



DUALUX

BRIDGELUX LED DUAL WALLWASHER

FOR WOOD CEILINGS

BI-DIRECTIONAL REFLECTED PLAN

ALLOW SLACK CABLE TO & FROM DRIVER CONNECTIONS FOR ACCESS FROM BELOW FINISHED CEILING

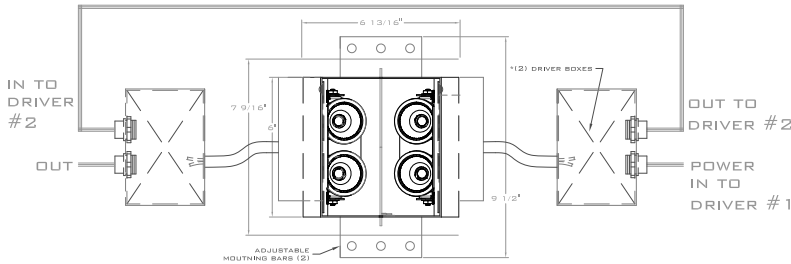

HALF BI-DIRECTIONAL REFLECTED PLAN

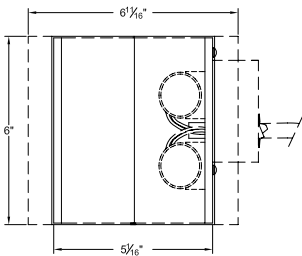

Nulux's LED products use the latest LED technology from the leading manufacturers of light engines and electronic power supplies and control devices.

The technology is evolving rapidly and to ensure that the latest product offerings are used we recommend that you:

1. Contact the factory for the latest documentation when in design/specification phase of a project.
2. Review the specifications at the time of bid/purchase

NOTES:

1. Kicker reflector
2. Lens support
3. (2) Solite lens
4. Housing - Steel
5. Finished Wood Ceiling
6. (4) Bridgelux VERO10 LED Module, see options below
7. Heatsink
8. Interior Finish
9. 6" Flexible Conduit
10. LED Driver, see options below
11. Driver Box

DUALUX Bi-Directional (4 lamp) & Half Bi-Directional (2 lamp) are cross aiming wallwashers that utilize Bridgelux VERO10 LED modules, each having a 5-1/16" x 6" rectangular aperture. DUALUX wallwashers express their function in a simple, readable form and a reduced scale. The slanted baffle can be finished to match the ceiling and the light opening is closed with Solite glass. DUALUX Bi-Directional & Half Bi-Directional are an ideal solution for use in corridors and work well in intimate modern environments due to their scale and the soft modulation of their light field. DUALUX is designed for flangeless installation into wood ceilings.

FEATURES:

- Dual cross-aiming wallwasher with 5-1\16" overall aperture
- Available in 4-lamp Bi-Directional and 2-lamp Half Bi-Directional modules
- Bridgelux VERO10 LED Module
- LED Driver
- Solite lens
- Non-IC thermally protected luminaire

DUALUX for gypsum is NRTL (Nationally Recognized Testing Laboratory) certified for purposes of OSHA safety standards product-approval requirements.

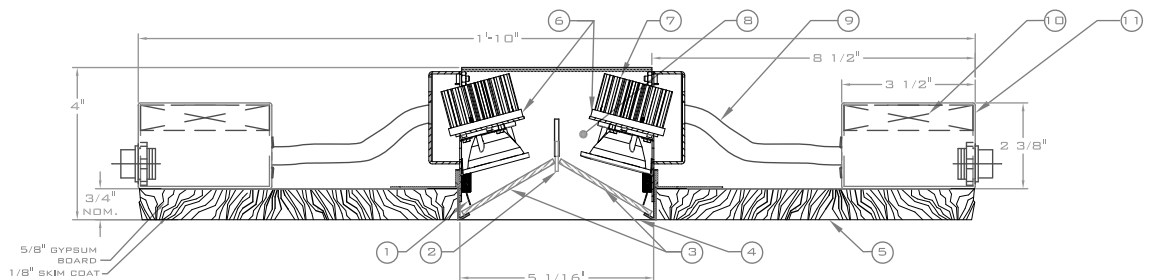

ORDERING MATRIX: DUA-W-BRL- _ _ _ _ _

Application	Driver	CRI	Color Temp (K)	Finish	Beam Spread	Trim Lens
A Bi-Directional	L Lutron	80 80	27 2700	W White	NF Narrow Flood	S Solite
B Half Bi-Directional	E EldoLED	95 95	30 3000	C Custom	N Narrow	SE Solite / Back Etch
	O Other *		O Other *			LE Linear Spread / Back Etch

* Contact NULUX directly to specify custom products
 Note: Retrofit Kit available for existing installations. Contact factory.